

Data subject to change without prior notice
Edition 02/2026 © 2026 JMG Cranes S.p.A. All rights reserved
Rev. 00

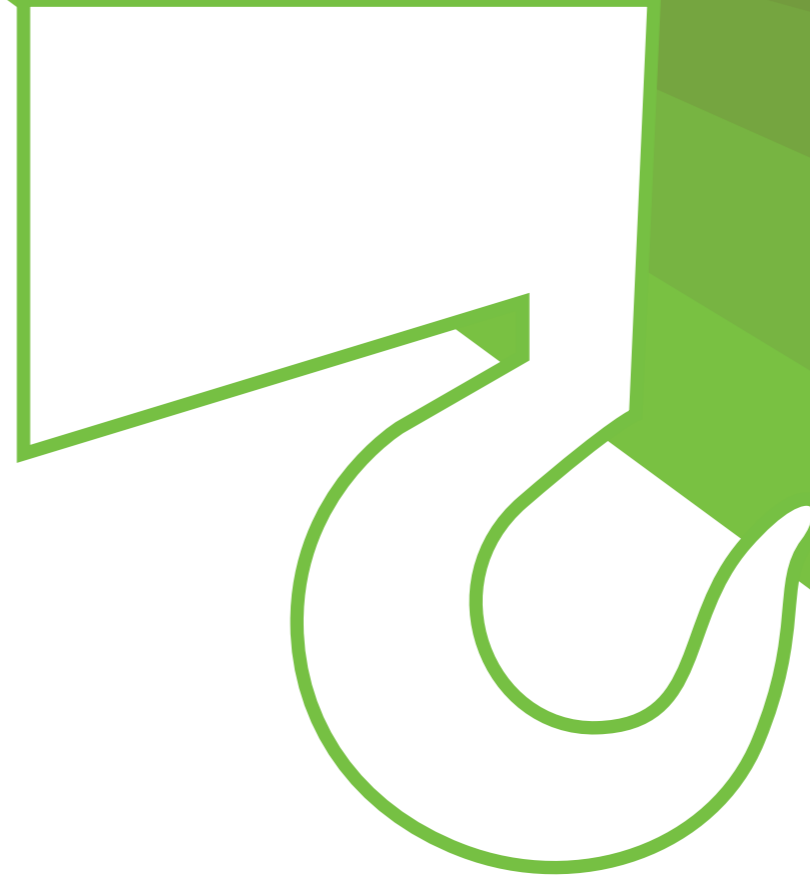

Electric pick & carry cranes



Greenlifter
(metric)
Maximum capacity
0,9t

EU standards CE

UNI ISO 4301-1: A1
2006/42 CE-2014/30 UE-2000/14 CE
and subsequent amendments.
EN 13000:2014-ANSI/ASME B30.5-2021
and subsequent amendments.



JMG Cranes S.p.A.

Offices and plant: Via dell'Innovazione, 3 - 29010 Sarmato (PC) - Italy

Registered Office: Via Dante, 15 - 26100 Cremona - Italy

Administration: Via Bergamo, 142 - 26100 Cremona - Italy

+39 0523 8486

info@jmgcranes.com

www.jmgcranes.com





Features

- Boom electro-hydraulic controls by battery operated radio-control
- Manual traction/steering
- Fully dismantable
- 20 removable sheet metal counterweights



Technical features

Maximum capacity	
	0,9t
Dimensions mm	
	2.341x1.740x1.570

- Manual drive
- Total kg 1.060
nr.20 removable counterweights kg 400
Removable battery kg 188
- Armoured plate battery 24V 240Ah
- nr.4 front polyurethanic 250x60 mm
nr.2 rear polyurethanic 200x50 mm
nr.2 mid wheels polyurethanic 200x50 mm with fixed support
- Rear steering angle -90°/+90°
- Boom electro-hydraulic controls by battery operated radio-control
- Mechanical parking brake on front wheels and negative drum brake to be activated by the steering helm on rear wheels
- Fabricated from preformed and welded quality steel plate
- Inclination angle +54°/-40°

Load charts

Capacity in kg

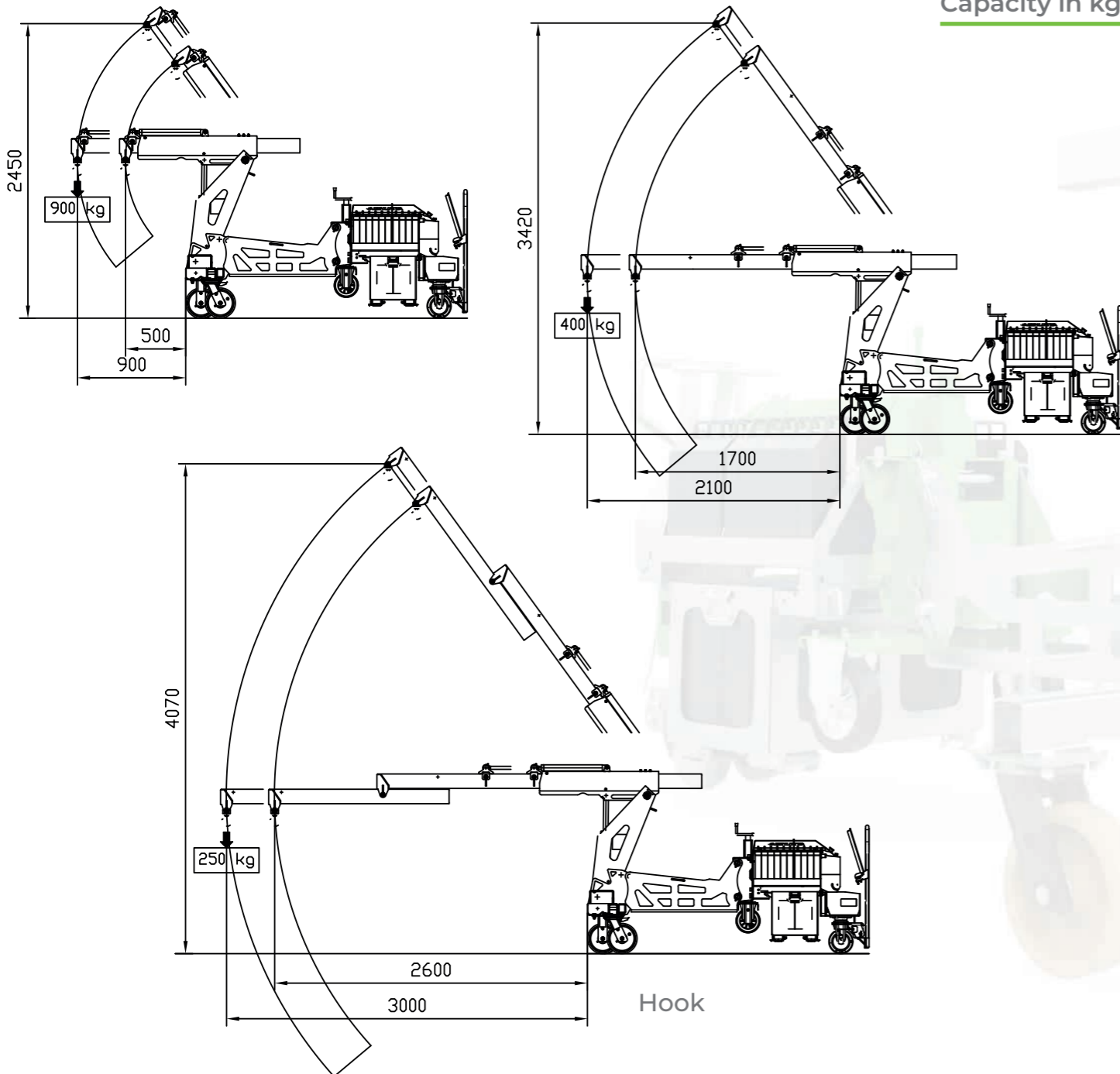

Overall dimensions

